

NEO-ANGLE DOOR - PARTS LIST

- A. 1 Pre-assembled Curb (with weep slots)
- B. 4 135° Anchor Plates
- C. 16 #6 x 3/8" Screws
- D. 1 Pre-assembled Header
- E. 2 Wall Jambs
- F. 8 1/4" Anchors
- G. 8 #8 x 2" Truss Head Screws
- H. 4 Plastic Setting Blocks
- J. 2 Fixed Glass Panels
- K. 2 135° Posts
- L. 1 Hinge Jamb (Attached to Door)
- N. 1 Strike Jamb Assy (Magnetic)
- P. 2 Snap-in Fillers
- R. 1 Assembled Door Panel
- S. 1 Handle Vinyl
- T. 1 Magnet Catch
- V. 1 Drip Vinyl
- CC. 1 Door Handle
- DD. 1 Door Handle Vinyl (8")
- JJ. 8 Pcs. Vert. Glazing Vinyl (72")
- KK. 8 Pcs. Horiz. Glazing Vinyl (36")

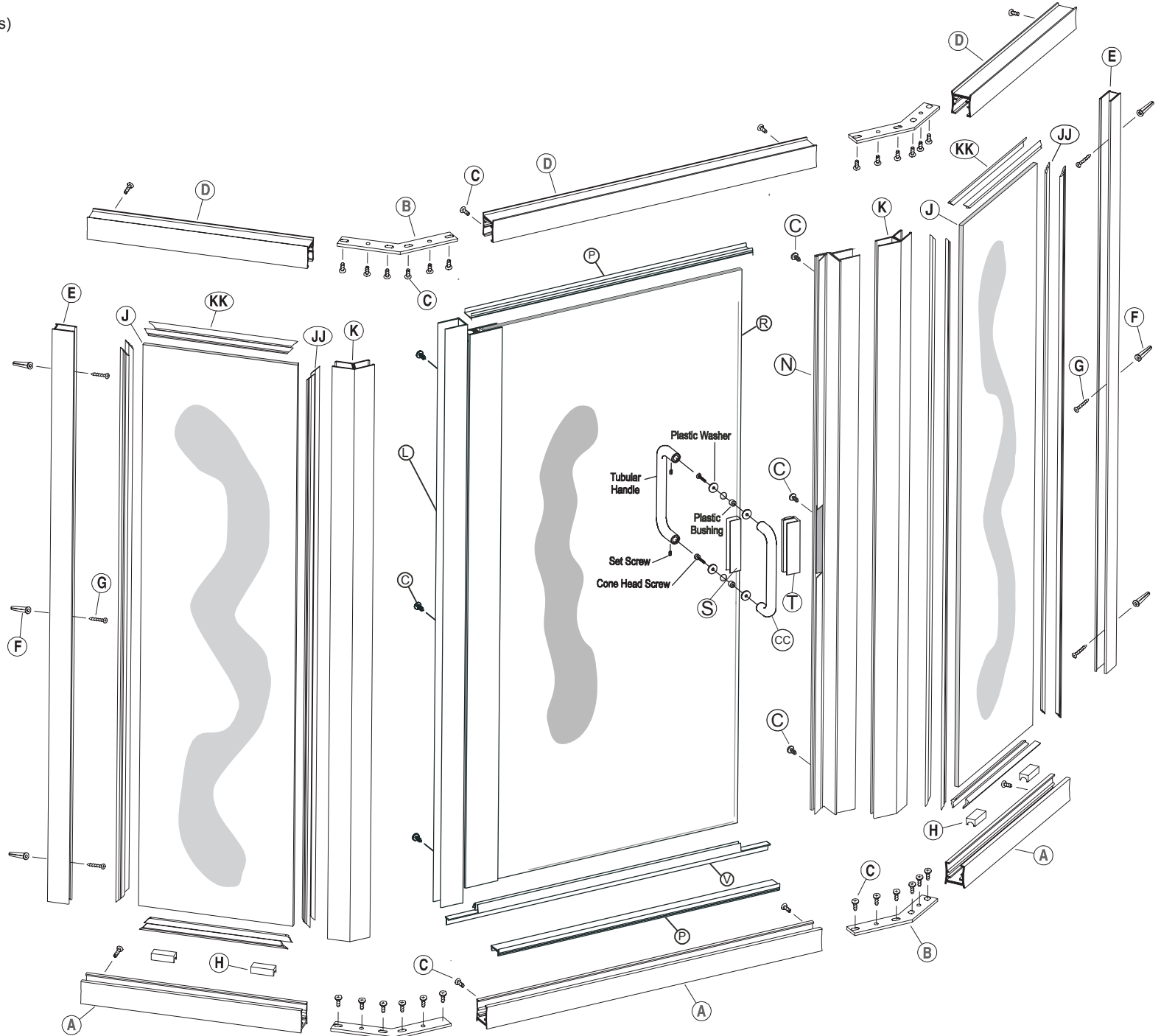

HARDWARE SPECS

Header

(Header Track is pre-assembled and will need to be trimmed down)



Wall Jamb

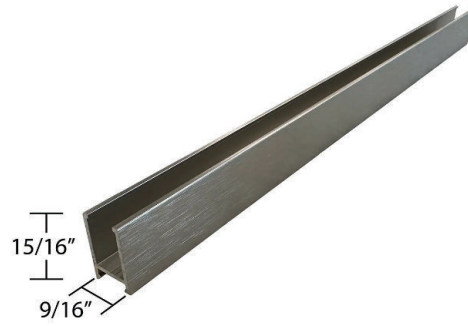

Curb Track

(Header Track is pre-assembled and will need to be trimmed down)

