

Enter Walk-In Right Curb Base Dimensions

Measurements entered below are:

Stud-to-Stud (most common)
(We will deduct 1/8" per wall for proper clearance)

Actual Size Needed
Please remember that bases need 1/8" clearance per wall side
(We will make exact as marked)

Choose Curb Style

Full Height

Mid Height

Low Profile

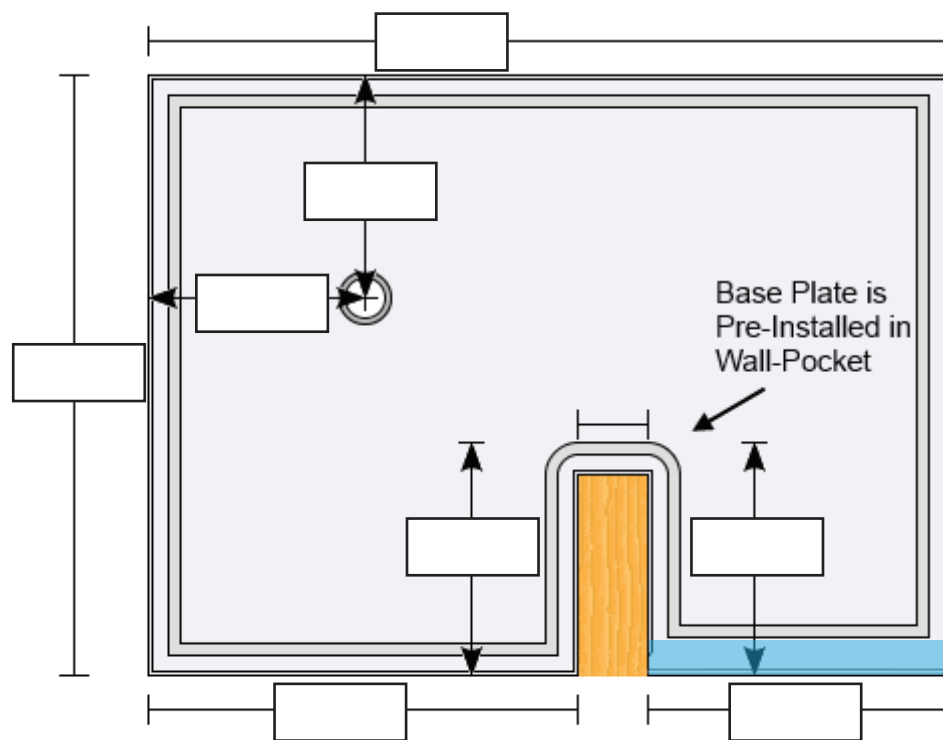

Comments

Your contact information:

Name:

Phone:

Email:

Zip:

To get a quote, contact an Onyx dealer

If you need help finding a dealer, download this
form and email it to us at info@onyxcollection.com