

WALL MOUNT SHOWER SEAT

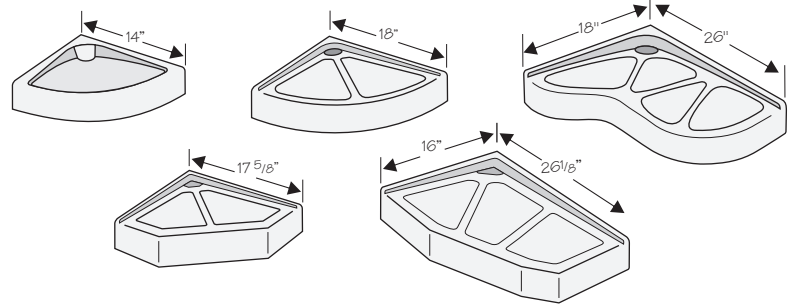

1 Wall Preparation

Wood backing is needed to support the Shower Seat. Install the backing as seen in the picture to the right. Use a 2" x 10" for the wood backing. Mount the backing so that its center is about 16" high off the floor. This will allow for the finished seat height to be 16" to 20" tall. If installing the Extended Corner Seat, be sure to extend the wood backing at least 24" from the corner.

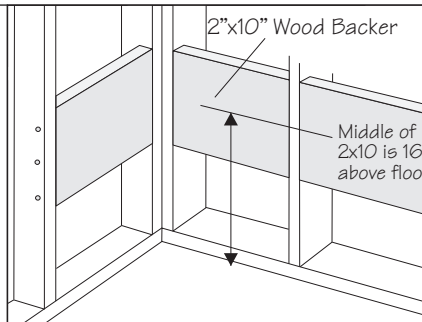

The 2" x 10" wood backer should be secured soundly to the wall studs. If using the Extended Corner Seat, be sure the wood backer extends to accommodate all the mounting holes in the seat.

2 Seat Location

After the shower wall is installed, position the corner seat at the desired height (normally between 17" and 19" above the base). Mark the wall through the pre-drilled holes under the seat for the hole locations. This step may require a second person to help.

Recommended Seat Height

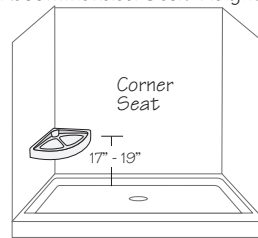

Putting tape on the shower wall and marking the location if the top of the seat may be helpful to maintain the correct height when marking for the holes.

3 Drilling the Holes

After holes are marked, pre-drill 1/4" pilot holes through shower walls and into wood blocking. Then enlarge just the hole through the shower wall (panel or tile) by drilling a 1/2" clearance hole. The lag bolts in the following step require the clearance hole through the shower walls.

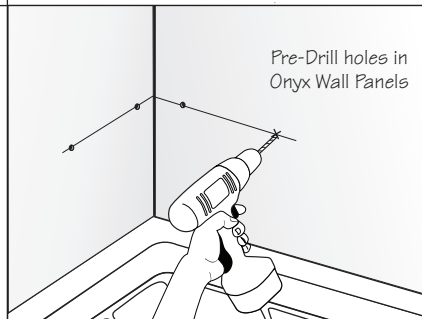

Regular drill bits can be used when drilling through Onyx wall panels. When enlarging the clearance hole, be careful not to drill into the wood backing.

4 Attaching the Seat

Apply Onyx Silicone Adhesive to the back of the seat before attaching to wall. (The silicone does help support and keep the seat from shifting). Hold the seat in position and insert the lag bolts through the holes. Tighten the bolts in sequence using a 9/16" socket wrench. The bolts should be tightened so that the seat will not move when sitting on it (It squeaks when it moves).

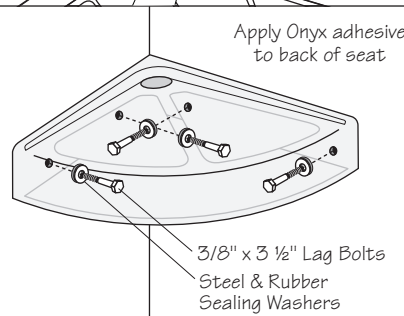

An easy test for how tight the bolts should be is to sit on the seat and listen for it to move (a squeaking sound). Tighten the bolts until the seat does not move.

Also, having a bottle of rubbing alcohol and roll of paper towels ready will help clean up any silicone that may squeeze out.

5 Securing & Sealing

After the seat is secured in place, use the Onyx color matched seamfill to fill the seams between the seat and the walls.

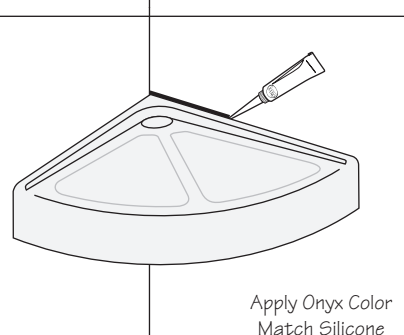

To smooth out a seamfill bead with your finger, dampen a paper towel with rubbing alcohol and then dampen your finger. Next, run your finger along the bead of seamfill, wiping any excess silicone onto the paper towel. The rubbing alcohol will keep the silicone from smearing.

14" Corner Seat Bolt Hole Spacing

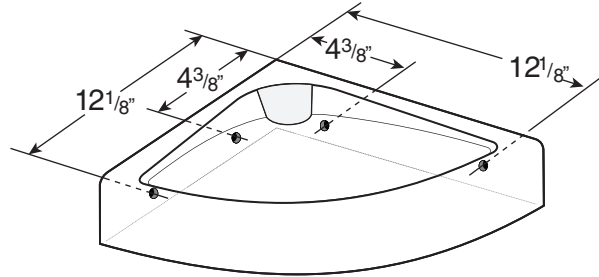

18" Corner Seat Bolt Hole Spacing

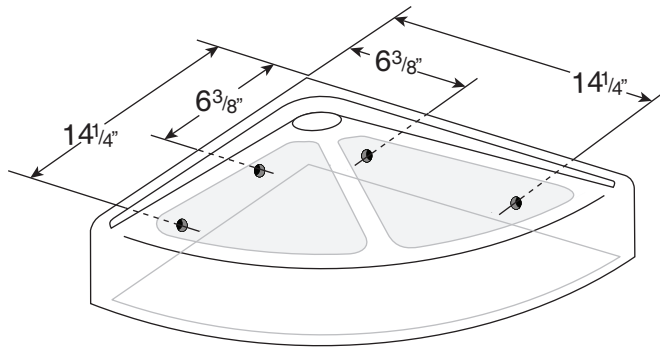

18" x 26" Extended Corner Seat Bolt Hole Spacing Left Side

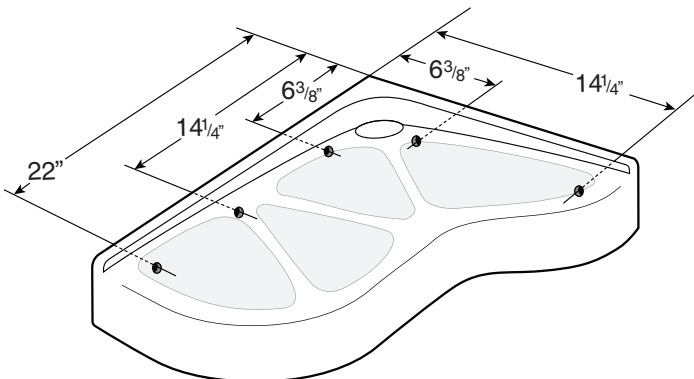

18" x 26" Extended Corner Seat Bolt Hole Spacing Right Side

